

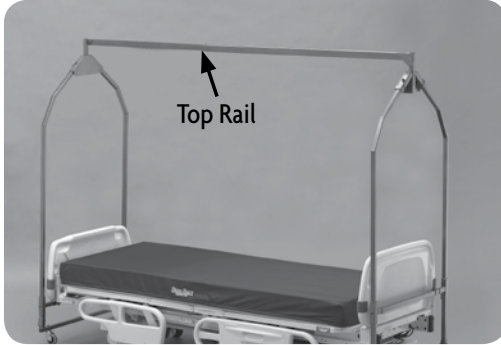

REF 8011 Top Rail System

To Assemble the Top Rail System:

The Posey StaySafe Bed Top Rail System was created to allow articulation of the Posey StaySafe Bed with greater ease and help eliminate the potential "Binding" that can occur. The System comes standard with the Posey StaySafe Bed 8060 model and retrofits to the 8040 model.



1. Remove the screw from part one.
NOTE: Leave pre-installed corner pads in place.

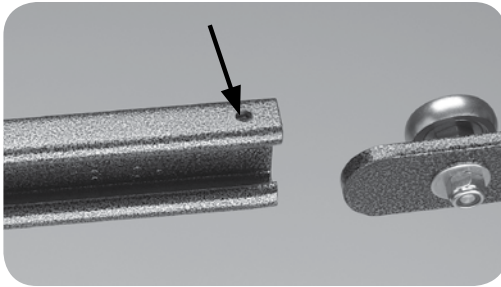

2. Holding both pieces, align the roller on part two with the slots on part one.

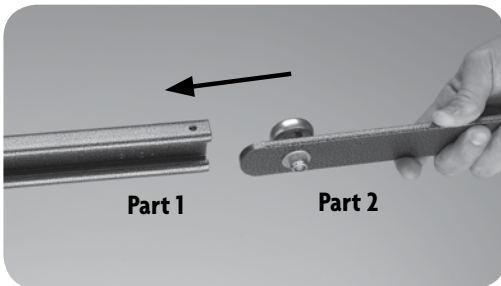

3. Slide the roller all the way into the slots, making sure to hold the two pieces together so they do not fall.

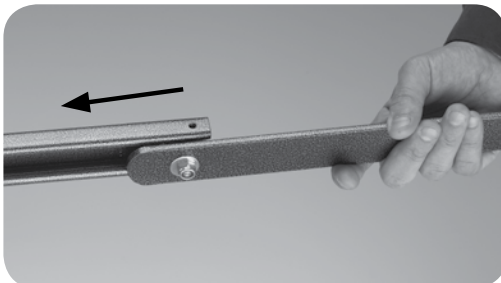

4. Replace the screw into part one.



5. **NOTE:** This step may require two people.

To place Top Rail System into frame, place each piece of the top rail into the metal retainers on each side as shown.



6. When the top piece is in place, the silver metal detent pin should be in the upper most hole in both A-Frames.

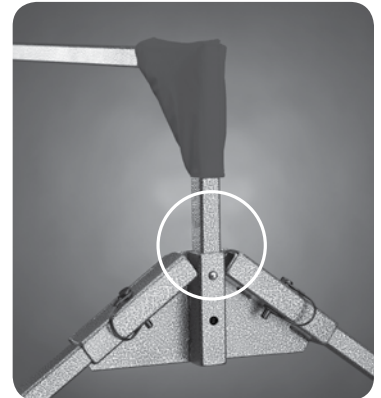

Storage and Handling

This device is designed for use in normal indoor environments. This device may be stored in ambient warehouse temperatures at normal humidity levels. Avoid excess moisture or high humidity that may damage product materials.

Disposal

⚠️ WARNING Properly dispose of the product per facility's policy for BIOHAZARDOUS materials.