

Before using this Fall Monitor, read entire instruction sheet and save for future reference.

The Posey KeepSafe Alarm is designed to alert the caregiver when a patient/resident attempts to exit from a wheelchair, geri-chair, or bed. The alarm sounds when weight is removed from the sensor. However, this device is not a substitute for good nursing care and regular visual monitoring, and may not be suitable for some "high fall risk" patients. Consult the physician or the healthcare team if you have any questions whether a Posey Fall Monitor is right for your patient.

Response:

Each facility should determine the appropriate protocol for responding to fall monitor alarms.

- REF 8350** Alarm Unit Only
- REF 8340** Alarm Unit with Chair Belt Sensor
- REF 8330** Alarm Unit with Chair Pad Sensor
- REF 8360** Chair Belt Sensor
- REF 8371** Mobile Chair Belt Sensor
- REF 7223F** Gel Foam Alarm Cushion
- REF 8283** 30-Day Over Mattress Sensor
- REF 8307** 6-Month Over Mattress Sensor
- REF 8308** 6-Month Chair Pad Sensor
- REF 8309** 30-Day Chair Pad Sensor





Alarm Unit Features:

- ON/OFF button. Green light blinks to indicate unit is "ON".
- Five selectable alarm tones/ patterns for patient identification.
- Alarm volume at least 95dB at one foot (1') from the alarm.
- Optional sound dampening plug.
- Two mounting options for use in bed or chair.
- Compact size: 2"x 4"x 1" (5 cm x 10 cm x 2 1/2 cm).
- Lightweight, 4-ounce unit.
- A single 9-Volt battery provides up to 280 hours of continuous alarm.
- Audible Low Battery Warning.

Selecting Alarm Tone:

1. Plug sensor into sensor plug receptacle (4) on the side of the alarm unit.
2. Turn alarm unit ON. The green light will blink to indicate unit is "ON".
3. To step through the five tone options, press the tone selector on the side of the unit. Pressing the tone selector will produce a two-second audio sample of each tone.
4. The last tone sample heard will be the tone selected for use until a new selection is made.

NOTE: The tone you select will affect battery life. Choose tone one (the single, rapid beep pattern) for the longest possible battery life. See Variable Tone Chart below.

VARIABLE TONE	CALCULATED BATTERY LIFE (BASED ON CONTINUOUS ALARM)
DEFAULT 	70 hours
Tone 1 	280 hours
Tone 2 	140 hours
Tone 3 	93 hours
Tone 4 	35 hours

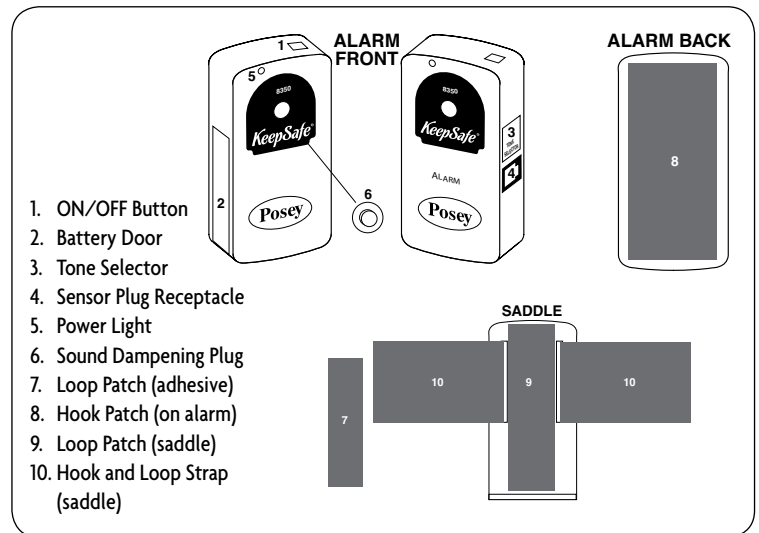

Optional Sound Dampening Plug:

To decrease the alarm volume, insert the Sound Dampening Plug into the hole on the face of the alarm unit. For maximum alarm volume, DO NOT use plug.

⚠ WARNING

- **NEVER** use sound dampening plug if patient can move out of hearing distance of staff by wheelchair or other means.
- **NEVER** place alarm unit closer than two feet from patient's ear (even if sound dampening plug is in use).

ALWAYS verify you can hear the alarm volume at the furthest possible distance before leaving patient unattended. **NEVER** place the alarm unit closer than two feet from patient's ear to minimize patient noise exposure. Refer to Occupational Safety and Health Administration Occupational Noise Exposure Standards 1910.95 for additional information.

Chair Pad Sensor Instructions

1. Place the Chair Pad Sensor across the width of the seat, directly under the patient's buttocks. If a seat cushion is used, place sensor ON TOP of cushion.
2. Turn alarm unit ON. The green light will blink to indicate the unit is "ON".
3. Plug sensor cable into receptacle (4) on the side of the alarm unit.
4. Alarm may fail to sound if the sensor pad is bent or folded under the patient, or if there is weight from an object on the pad.
5. Make sure sensor cable does not contact moving parts of chair and does not pose a tripping hazard.



Bed Pad Sensor Instructions

1. Place the sensor pad on the mattress directly under the patient's weight. Most patient weight is under the buttocks. See sensor pad label for other positions when head of bed is elevated.
2. Use sensor pad clips at each end to attach sensor to the mattress.
3. Be sure to route sensor cable to the alarm unit so it is clear of all moving parts of bed to prevent damage to the cable or the pad when bed is raised or lowered, or when head or knee sections are operated.
4. Alarm may fail to sound if the sensor pad is bent or folded under the patient, or if there is weight from an object on the pad.
5. Make sure sensor cable is not in the footpath and does not pose a tripping hazard.

Alarm Unit Mounting Instructions - Saddle Mount

1. Choose a secure location out of the patient's reach, preferably in the rear, below the chair seat (Fig. 1).



2. Wrap the saddle strap firmly around a bar of wheelchair or bed frame. Check that saddle is secure and will not move.
3. Press hook material on alarm unit firmly to loop material on saddle (Fig. 2).



4. Check that alarm unit and sensor cable are clear of all moving parts of the chair.

Hook and Loop Mount

1. Choose site on head or footboard or other mounting surface, i.e. nightstand, out of the patient's reach.
2. Clean site with alcohol wipe and let it dry.
3. Attach self-adhesive loop (fuzzy) patch (7). Peel off backing and press into place on the mounting surface. **NOTE:** Adhesive on loop will not adhere to vinyl or other slick surface.
4. Press the hook (rough) patch (8) on back of alarm unit firmly to the loop patch on mounting surface. Be sure alarm unit is secure and will not move.

Battery Replacement

The alarm unit will emit an audible "CHIRP", indicating a low battery. To replace the battery:

1. Turn the alarm OFF.
2. Press down on arrow and slide the battery door open.
3. Remove the battery from the compartment and hold in one hand with thumb on the terminal cap. Battery connection wires should be away from the thumb. DO NOT pull the terminal cap wires.
4. Use thumb to push the terminal cap up, off the battery (Fig. 3).
5. Connect terminal cap to the new battery. Make sure the battery is securely connected to the terminal cap and insert into alarm unit.
6. Slide battery door closed.
7. Test system to verify it is working properly before leaving patient unattended.

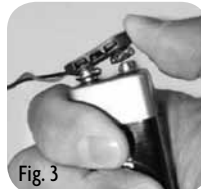

⚠ WARNING

- Batteries can explode or leak and cause damage to alarm or skin if installed backwards, disassembled, fully discharged or exposed to water, fire or high temperatures.
- **ALWAYS** install a completely new set of batteries when the chirping due to low battery power sound begins; DO NOT replace a single cell, but all cells in the alarm unit.
- Installing batteries incorrectly can cause batteries to utilize more power than normal and discharge sooner, causing possible corrosion. Take care when installing new batteries.

Before Leaving Patient Unattended

⚠ WARNING

ALWAYS follow these steps each time before leaving patient unattended:

1. Connect a Posey sensor to the alarm unit. Check to make sure that the sensor cable and RJ11 are intact and undamaged.
2. Place weight on sensor pad.
3. Turn alarm unit ON and verify green light blinks.
4. Verify batteries are fresh. If you hear an intermittent "CHIRP", the battery is low and needs to be changed.
5. Check to make sure the audible alarm is functioning properly by applying and lifting weight off sensor in several spots to activate the alarm.
6. DO NOT use the Posey KeepSafe if the audible alarm does not sound.
7. Check to make sure sensor cable is out of the way and does not pose a tripping hazard. If cable must cross footpath, use duct tape or similar product to secure cable to floor and reduce hazard.

NOTE: If the sensor is damaged or disconnected while in use, alarm will sound to notify caregiver.

Cleaning Instructions

- Alarm Unit and Saddle Mount – Wipe clean with disinfectant liquids that DO NOT contain Phenol or Benzyl. DO NOT submerge in liquid or sterilize with heat.
- Hook and Loop – Use stiff brush to remove dust and lint.

Proper Handling And Use

If the Posey KeepSafe is subjected to severe mechanical shock, such as dropping, or is submerged in liquid, it may stop functioning as designed. Visually inspect the unit for cracks in the case, missing screws, missing battery door, broken wires or signs of exposure to liquid. After each incident, you must verify that the unit is working properly.

Storage Instructions

- This device is designed for use in normal indoor environments.
- This device may be stored in ambient warehouse temperatures at normal humidity levels. Avoid excess moisture or high humidity that may damage product materials.

Disposal

Dispose of per your facility policy or applicable local code for BIOHAZARDOUS material.

⚠ WARNING

- Read sensor and alarm instructions prior to use.
- **NEVER** connect Posey sensors to other manufacturers' alarm units.
- **NEVER** connect other manufacturers' sensors to Posey alarm units.
- **ALWAYS** test system per instructions prior to use.
- **NEVER** pull the sensor cable from the alarm. Doing so will damage the connections and may prevent the alarm from sounding. **ALWAYS** use the lever to release the RJ11 from the alarm unit.
- This device may not be suitable for use with all "high fall risk" patients.
- This device should not be a substitute for maintaining the routine visual monitoring protocol by healthcare personnel.
- This device provides the earliest possible warning that a patient is at immediate risk of falling. This device does not prevent falls.
- When used, be sure restraint straps DO NOT cross over sensor pad! Restraint straps may prevent alarm activation if patient falls out of bed or chair.
- The alarm may fail to sound if the sensor pad is folded or bent.
- **ALWAYS** make sure the sensor cable does not contact moving parts of the chair.
- **ALWAYS** make sure the sensor cable is clear of all moving parts of the bed to prevent damage to the sensor and cable when the bed is articulated.
- **ALWAYS** make sure the sensor cable does not pose a tripping hazard.

Limited Lifetime Warranty:

The Posey Company warrants to the original purchaser, the alarm unit to be free from defects in materials and workmanship for the life of the unit. Warranty void if unit is opened, damaged, or submerged. This warranty gives you specific legal rights, and you may also have other rights, which vary from state to state.